

ANOUR

X MODEL CORDLESS

Installation manual

Please, read our instructions before installing and using the product.

If you have any problems with the electrical installation, contact an electrician. Be sure to turn off the power before you start the installation. In some countries, all electrical installation must be carried out by professional electricians only. For further information, contact the relevant authorities.

Our products are for indoor use only. Check on a regular basis that the cord and other parts are not damaged. In this case, the product must not be used. Save these instructions for future use.

We use LED as a light source for our products. For replacement of LED contact Anour. The product should not be dismantled as it may get damaged. The product should not come into direct contact with water.

Our products are marked with the symbol of the crossed out wheelee bin. That means that the product should not be disposed of with other household waste. Our products must be recycled in accordance with local environmental regulations for the disposal of waste. In complying with this you will help to minimize any adverse effect on human and environmental health. If you have any questions please contact Anour. contact@anour.dk (2017)

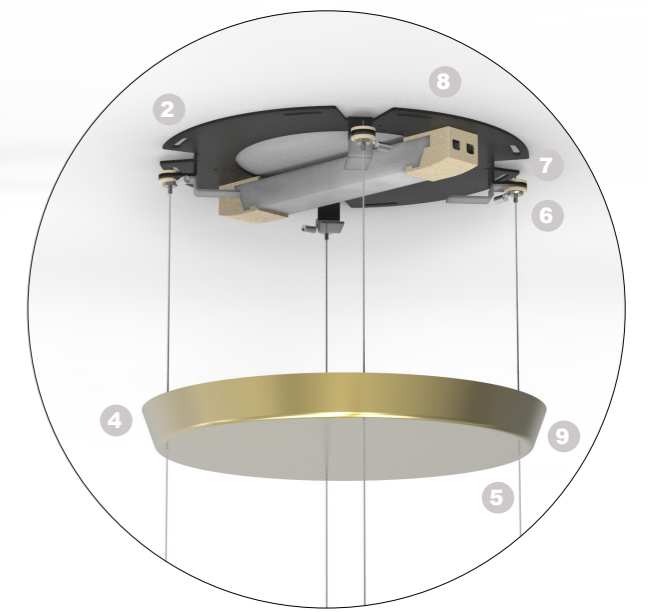
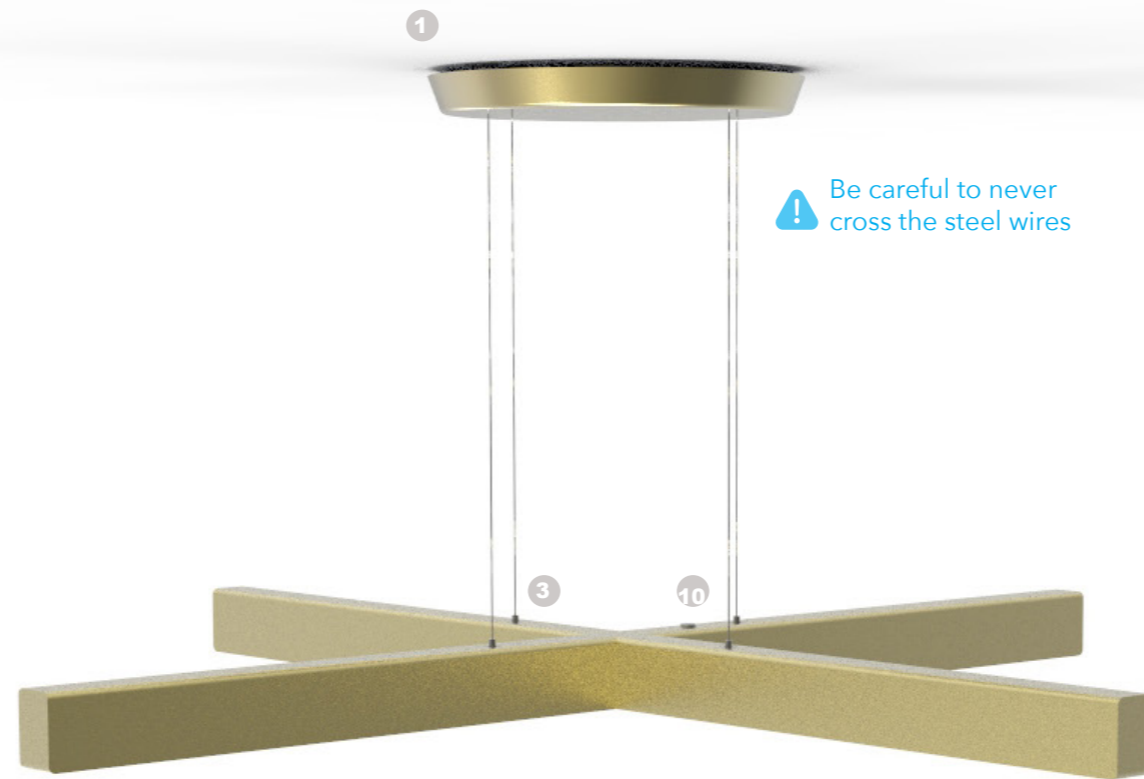

EQUIPMENT

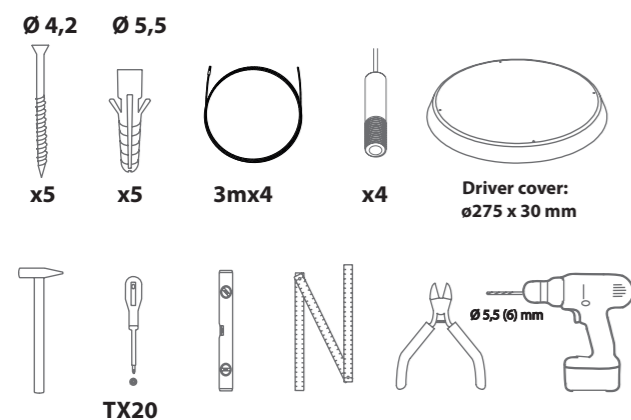

DIAGRAM

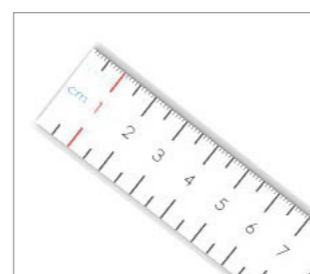
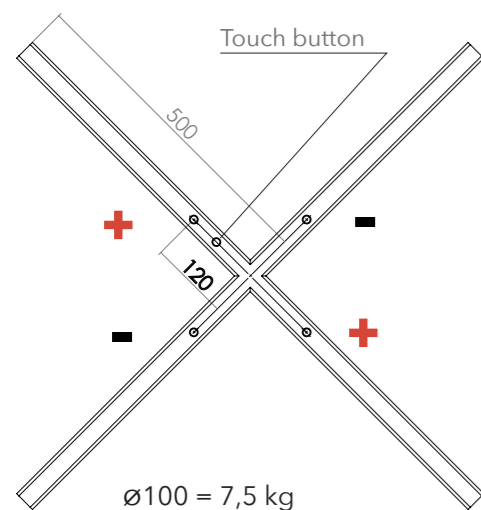

1. Position & measurement.



2. Drill 5 holes, place the anchors and fasten the ceiling bracket. Make sure it is equally fixed.



3. Insert the 4 wires through the 4 nipples and tightly fasten the wires to the lamp.

⚠ The positive pole is the suspension point closest to the touch button.

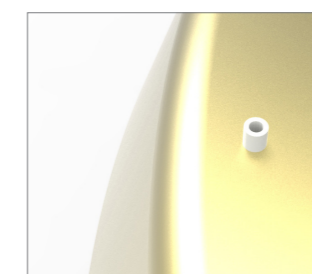

4. Verify that the 4 plastic insulation tubes are well in place in the 4 holes of the rosette cover.



5. Insert the 4 wires through the holes of the rosette cover



6. Insert the 4 wires through the 4 wire grippers.

⚠ Follow the color code
Insert the + wires in the + terminals and the - wires in the - terminals.

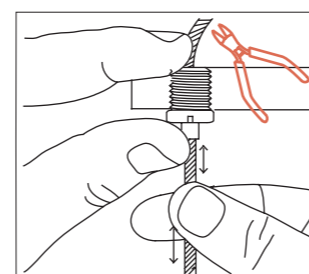

7. Adjust the position of the lamp and then cut the excess of wire. Wires can't touch anything.

TIP: Suspend the light +/- 70cm above table top.

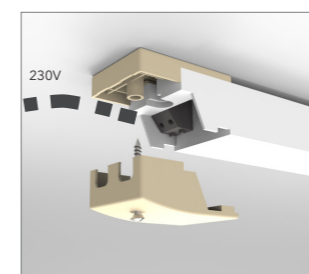

8. Connect the primary power cable to the terminals on the primary side of the power supply and then, fasten the screw of the safety cap.

⚠ Should be performed according to safety regulations.



9. Close the box / Magnetic closure.

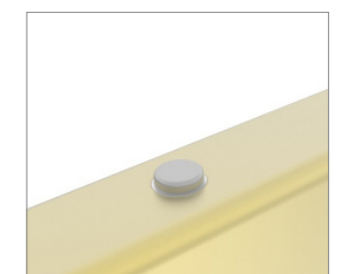

10. On / Off / Dimming.
• One tap on the button = On/Off.
• Long touch on the button: = brighten or dim.
• Double tap: for max or min brightness

⚠ If the button does not respond, turn off main power for the duration of 30 sec and try again.